

# System Forty & Fifty

Economical autopilots with three ATI-size,  
panel-mounted mode selector/programmer/annunciators

**COBHAM**

The most important thing we build is trust



# System Forty & Fifty

Economical autopilots with three ATI-size, panel-mounted mode selector/programmer/annunciators

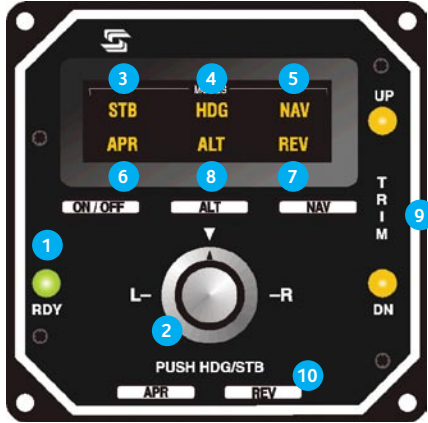

- 1 **Ready.** Indicates A/P ready status and reliable gyro speed.
- 2 **Multi-function control knob.** Turn command, or push to select heading hold or roll stabilization mode
- 3 **Roll stabilization mode.** Holds wing level and enables command knob for A/P commanded turns up to 90% standard rate.
- 4 **Heading pre-select and hold.\***
- 5 **NAV/LOC/GPS tracking.** Dual gain NAV for en route tracking and smooth station passage.

- 6 **APR for GPS en route, and LOC, VOR & GPS approaches.**
- 7 **REV for backcourse approaches.**
- 8 **Altitude hold.\***
- 9 **Pitch trim annunciator.** Advises if up or down elevator trim required with altitude hold engaged\*
- 10 **Mode selector buttons.**

\* System Fifty features and functions

## System Forty

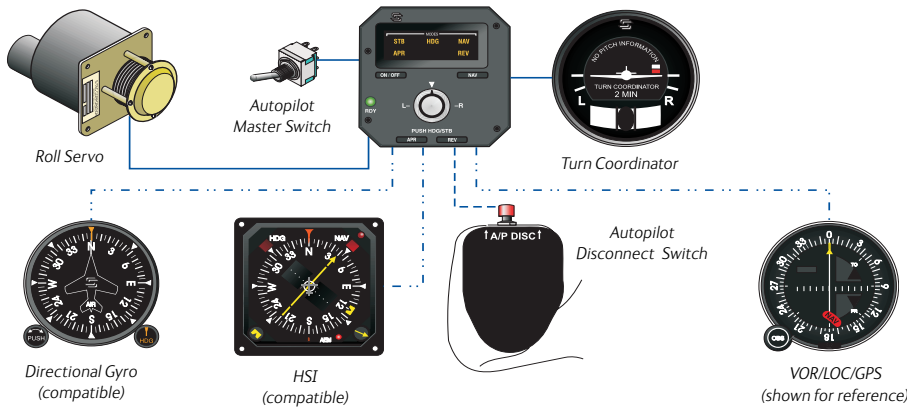

## System Forty: features and functions

- 3" ATI panel-mounted
- Internal lighting
- Roll axis computer three ATI case-contained
- Heading preselect and hold\*\*
- Turn command in "STB" roll stabilization mode
- Low and high gain VOR/LOC/GPS tracking (track only)
- Back course (REV) mode

## System Fifty: features and functions

- Same roll features/functions as System Forty
- Altitude hold (only)
- Pitch axis computer three ATI case-contained
- Pitch trim annunciation

## Options

- Control wheel altitude hold select
- GPSS (GPS. Steering) converter
- DG / HSI compatible
- Manual electric trim (where STC'd)
- Yaw Damper

\*\*Operational if heading system (e.g., DG with heading bug) is installed and active.

## System Fifty

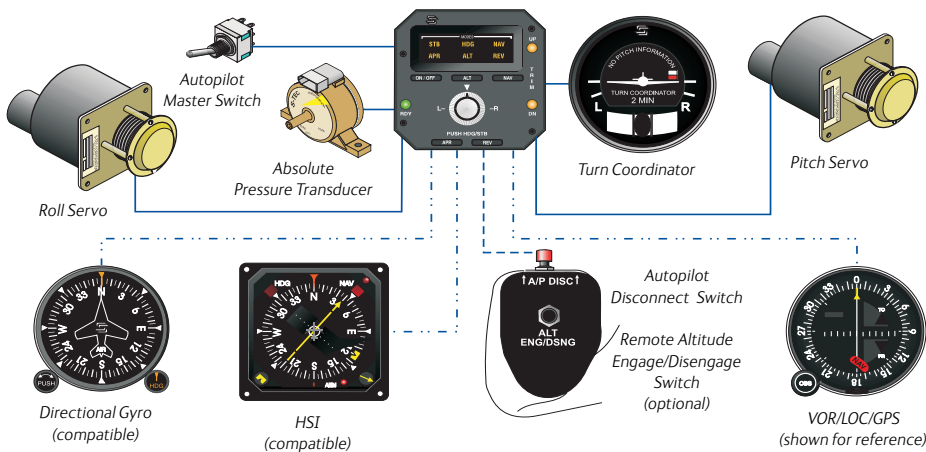

## For further information please contact:

Cobham Avionics, Integrated Systems  
 One S-TEC Way  
 Municipal Airport  
 Mineral Wells, TX 76067 USA  
 Tel: (800) 872-7832  
 (817) 215-7600  
 Fax: (940) 325-3904  
 Email: info@s-tec.com